

UNCONTROLLED WHEN PRINTED

USER: RCLMNT; PLOT: DRIVER; PLOT: DOT; PLOT: MONO; PLOT: TRCF; PLOT: DATE: 05-30-2017 9:49:45 AM; PATH: O:\00001\CON094634\0000000024562\6\_0\_CAD\_BLM\6\_2\_Wrk\In\_Progress\6\_2\_2\_Contract\Files\J246-Traffic-Control.dgn; FILE: RBRP-J246-TC-DETOUR.dgn

DISTRICT	COUNTY	ROUTE	SECTION	SHEET
8-0	DAUPHIN	2012	000	2 OF 4
DERRY TOWNSHIP				
REVISION NUMBER	REVISIONS	DATE	BY	

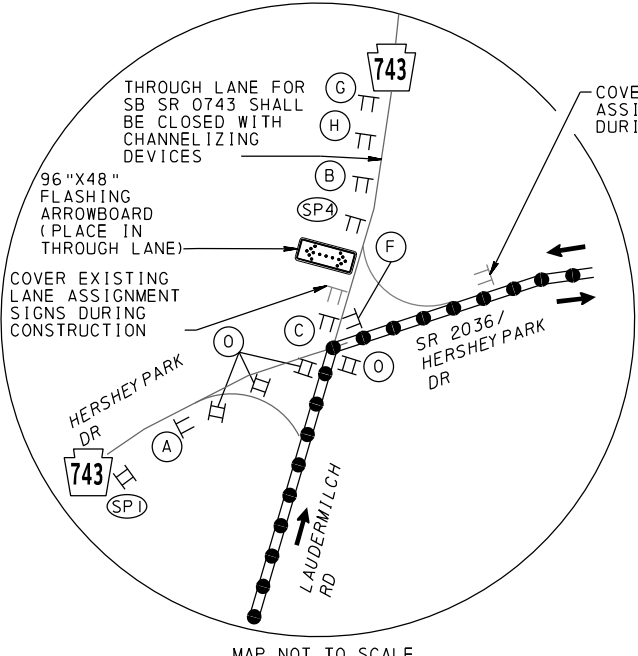
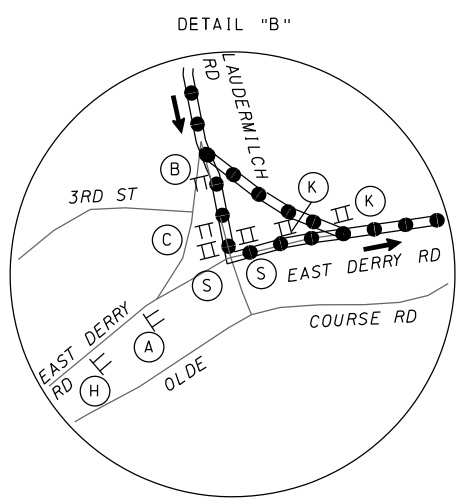
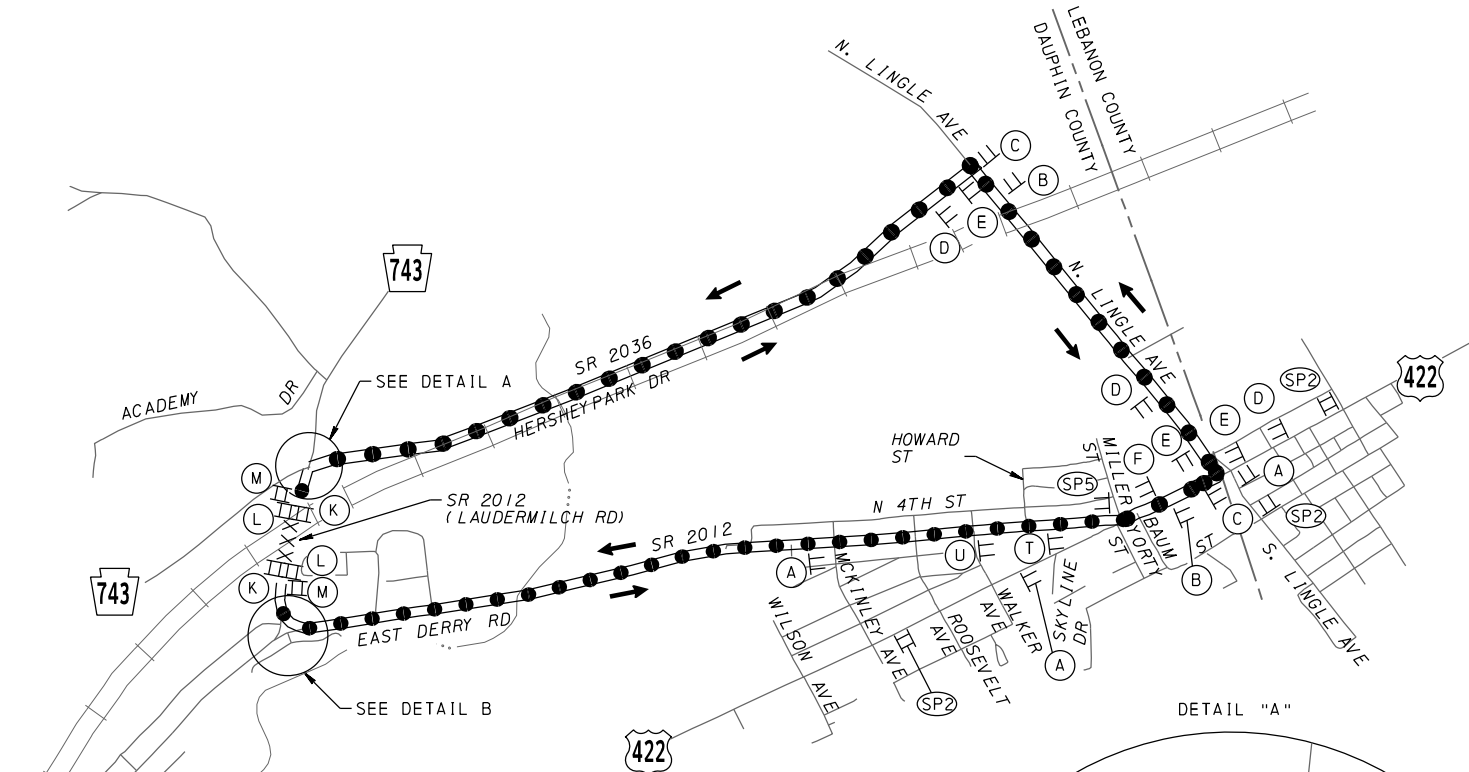

- XXXXX AREA OF CLOSURE
- DETOUR ROUTE
- ↔ TRAFFIC FLOW
- TT TEMPORARY SIGN
- TT EXISTING SIGN
- II TYPE III BARRICADE
- (A) SIGN LETTER

DETAIL A: CONTRACTOR SHALL SUPPLY SUFFICIENT CHANNELIZING DEVICES TO CLOSE OFF WB HERSHEY PARK DR. LEFT TURN LANE AT LAUDERMILCH RD, AND THE EB HERSHEY PARK DR. CONNECTION TO SB LAUDERMILCH RD.

DETOUR LENGTH = 2.05 MILES  
MAP NOT TO SCALE

JV NO. 246 / MPMS 47519

DES: NJP DWG: NJP CKD: RC

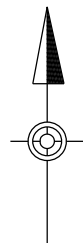

(A)	LAUDERMILCH ROAD DETOUR ↑	SP-3 30"X18" M4-9S 30"X24"	(D)	LAUDERMILCH ROAD DETOUR →	SP-3 30"X18" M4-9SR 30"X24"
(B)	LAUDERMILCH ROAD DETOUR ←	SP-3 30"X18" M4-9SL 30"X24"	(E)	LAUDERMILCH ROAD DETOUR →	SP-3 30"X18" M4-9R 30"X24"
(C)	LAUDERMILCH ROAD DETOUR ←	SP-3 30"X18" M4-9L 30"X24"	(F)	LAUDERMILCH ROAD END DETOUR	SP-3 30"X18" M4-8A 24"X18"
(SP1)	LAUDERMILCH ROAD CLOSED AT PA 743 FOLLOW DETOUR	SP-1 48"X36" 5" TYPE B FONT	(G)	DETOUR 1500 FT	W20-2 36"X36" R11-2 48"X30"
(SP2)	LAUDERMILCH ROAD CLOSED AT DERRY RD FOLLOW DETOUR	SP-2 48"X36" 5" TYPE B FONT	(H)	DETOUR 1000 FT	W20-2 36"X36" W30-1-2 20"X6"
(T)	LAUDERMILCH ROAD DETOUR ←	SP-3 30"X18" M4-9-1BL 30"X24"	(K)	ROAD CLOSED	R11-2 48"X30"
(U)	LAUDERMILCH ROAD DETOUR →	SP-3 30"X18" M4-9-1AL 30"X24"	(L)	ROAD CLOSED	R11-2 48"X30"
(SP5)	NO TRUCKS ABOVE CLASS 4 EXCEPT LOCAL DELIVERIES 1/4 MILES AHEAD	SP-5 48"X42" 4" TYPE B FONT	(M)	THIS BRIDGE TO BE CLOSED FOR CONSTRUCTION MM/DD/YYYY	W23-101 96"X48"
(SP4)	HERSHEY CC FOLLOW DETOUR	SP-4 36"X18" 4" TYPE B FONT	(O)	ROAD CLOSED	R11-2 48"X30"
	LAUDERMILCH ROAD	SP-3 30"X18" 5" TYPE B FONT	(R)	ROAD CLOSED	R11-2 48"X30"
	LAUDERMILCH ROAD	SP-3 30"X18" 5" TYPE B FONT	(S)	ROAD CLOSED 400 FEET AHEAD LOCAL TRAFFIC ONLY	R11-3A 60"X30"

NOTE: TYPE III BARRICADE EXTENDS ACROSS THE EXTENT OF THE ROADWAY

NOTE: TYPE III BARRICADE EXTENDS ACROSS THE EXTENT OF THE ROADWAY

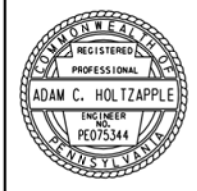

DETOUR PLAN  
SR 2012  
(LAUDERMILCH ROAD) CLOSED  
TRAFFIC CONTROL PLAN

APPROVED FOR CONSTRUCTION