

UNCONTROLLED WHEN PRINTED

USER: c:\p1\zdp... PLOT DRIVER: PcmDOT.PDF... MONO: p1\trcf9... PLOT DATE: 07-26-2017 7:47:30 AM... PATH: 000001\CON094634\00000000245565\6_0_CAD_BLM\6_2_2_Contr\001.F\1es\1... FILE: RBRP-JV248-TC-DETOUR.dgn

NOTE: TEMPORARY TRAFFIC SIGNAL AND TEMPORARY SIGNING AND PAVEMENT MARKINGS TO BE INSTALLED (BY PWKP) ON US 30 AT DCNR ACCESS ROAD DURING DETOUR ROUTE OPERATION. SEE TEMPORARY SIGNAL AND SIGNING AND PAVEMENT MARKING ALSO PLANS.

DISTRICT	COUNTY	ROUTE	SECTION	SHEET	
8-0	FRANKLIN	0233	000	2 OF 2	
GREENE TOWNSHIP					
REVISION NUMBER	REVISIONS			DATE	BY

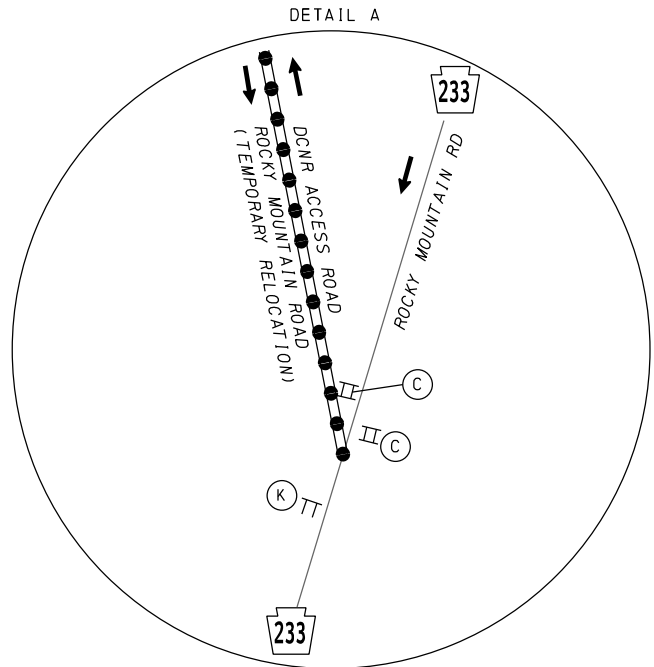
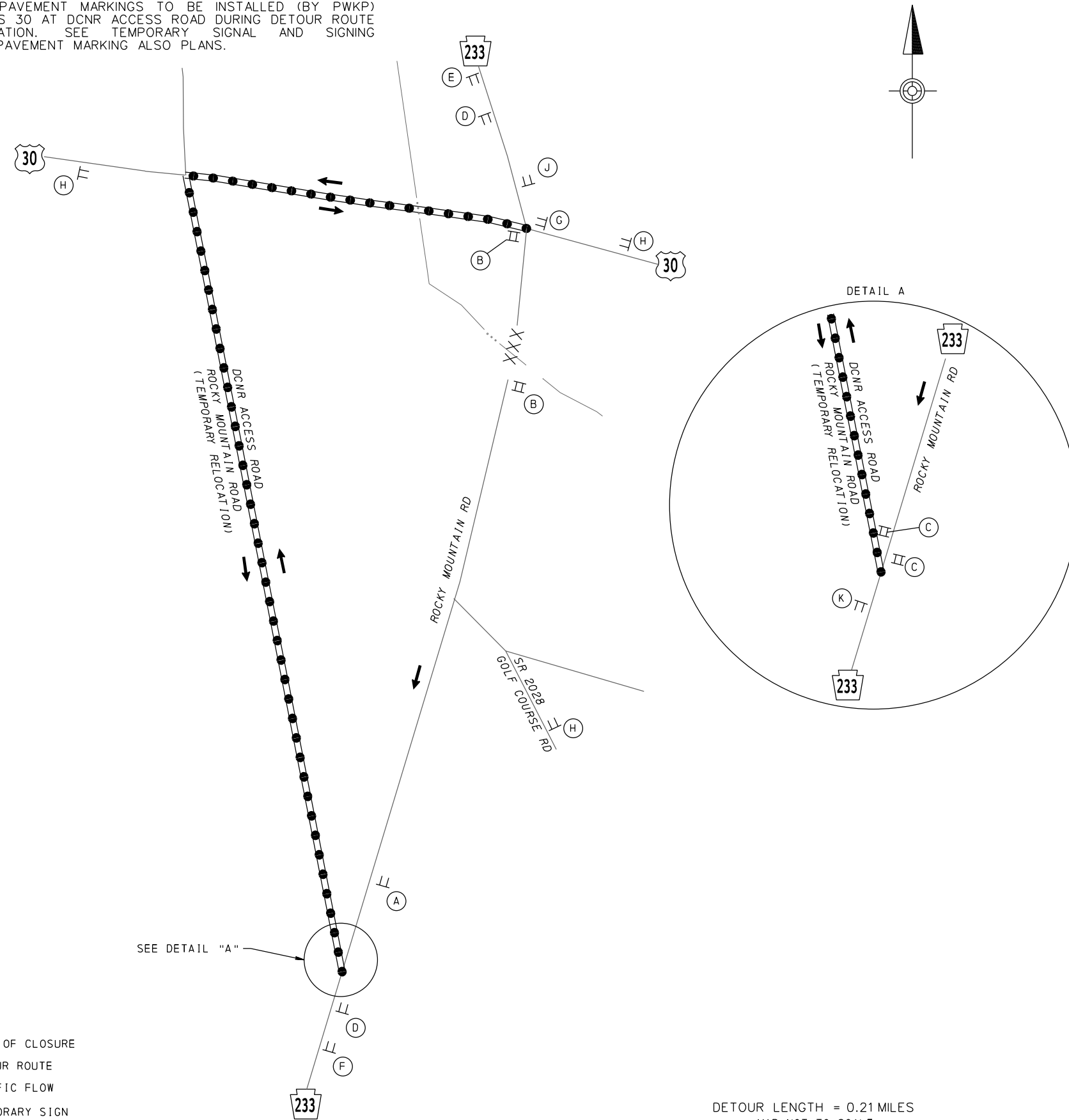

- (A) ROAD CLOSED 500 FT
W20-3 36"x36"
W30-1-1 20"x6"
- (B) THIS BRIDGE TO BE CLOSED FOR CONSTRUCTION MM/DD/YYYY
W23-101 96"x48"
- (C) ROAD CLOSED 500 FEET AHEAD LOCAL TRAFFIC ONLY
R11-3A 60"x30"
M4-10L 48"x18"
- (D) DETOUR 1500 FT
W20-2 36"x36"
W30-1-3 20"x6"
- (E) ROAD CLOSED 1/2 MILE
W20-3 36"x36"
W30-1-4 20"x6"
- (F) DETOUR 1/2 MILE
W20-2 36"x36"
W30-1-4 20"x6"
- (G) SOUTH 233
M3-3 24"x12"
M1-5 30"x24"
M6-3 21"x15"
- (H) DETOUR AHEAD
W20-2 36"x36"
W30-1-6 20"x6"
- (J) END DETOUR NORTH 233
M4-8A 24"x18"
M3-1 24"x12"
M1-5 30"x24"
- (K) END DETOUR SOUTH 233
M4-8A 24"x18"
M3-3 24"x12"
M1-5 30"x24"

* - TYPE III BARRICADE OR POST MOUNTED TYPE B SIGNS.

- LEGEND
- XXXXXX AREA OF CLOSURE
 - DETOUR ROUTE
 - ←→ TRAFFIC FLOW
 - TT TEMPORARY SIGN
 - || TYPE III BARRICADE
 - (A) SIGN LETTER

DETOUR LENGTH = 0.21 MILES
MAP NOT TO SCALE

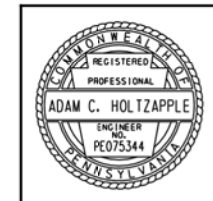

DETOUR PLAN SR 0233
(ROCKY MOUNTAIN ROAD)
CLOSED

TRAFFIC CONTROL PLAN

APPROVED FOR CONSTRUCTION

UNCONTROLLED WHEN PRINTED

APPROVED FOR CONSTRUCTION