

DISTRICT	COUNTY	ROUTE	SECTION	SHEET
12-0	WESTMORELAND	0136	000	2 OF 2
HEMPFIELD TOWNSHIP				
REVISION NUMBER	REVISIONS	DATE	BY	

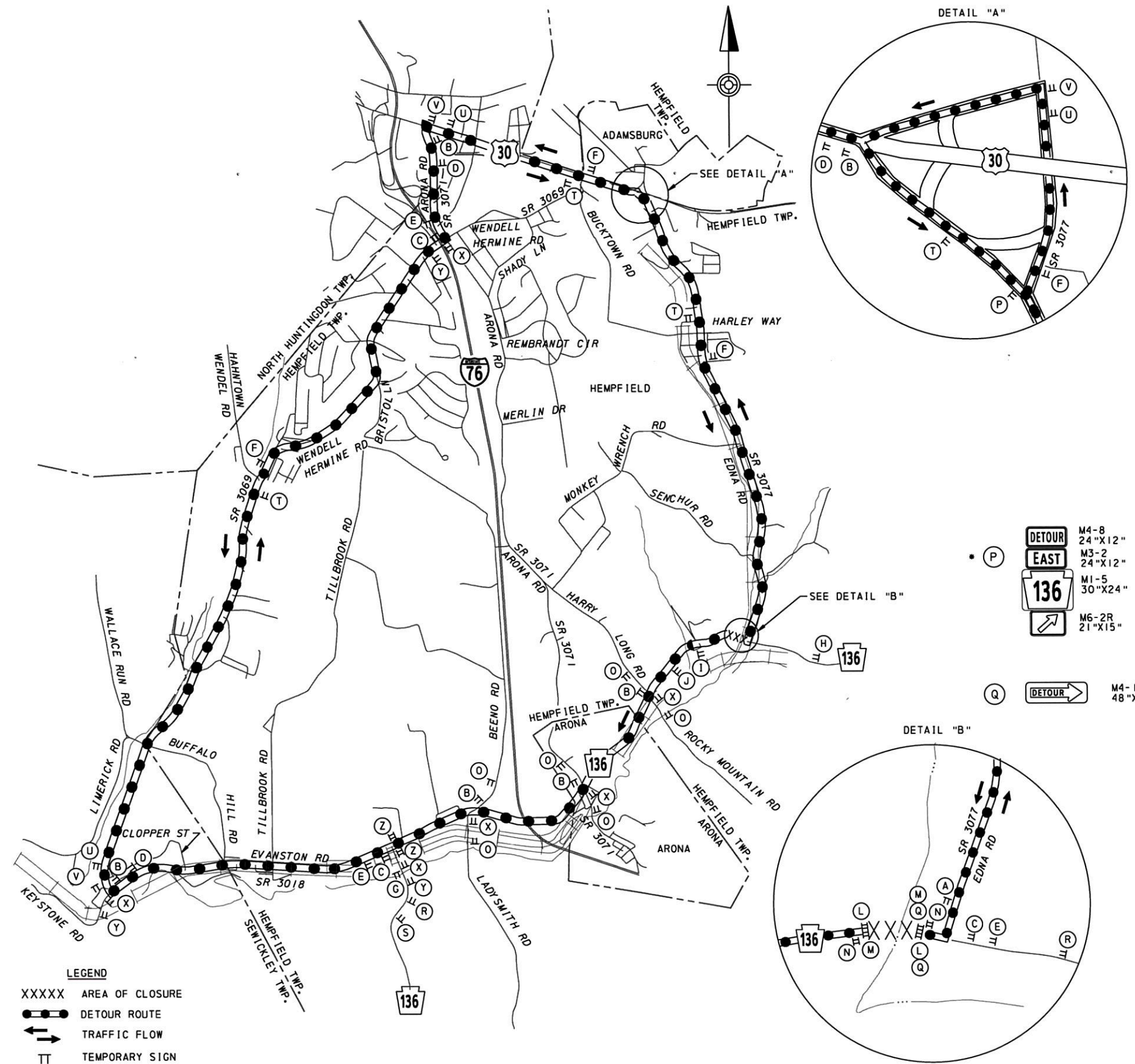

• A	END DETOUR EAST 136	M4-8A 24"x18" M3-2 24"x12" M1-5 30"x24"
• B	DETOUR EAST 136	M4-8 24"x12" M3-2 24"x12" M1-5 30"x24" M6-1 21"x15"
• C	DETOUR WEST 136	M4-8 24"x12" M3-4 24"x12" M1-5 30"x24" M6-1 21"x15"
• D	DETOUR EAST 136	M4-8 24"x12" M3-2 24"x12" M1-5 30"x24" M5-1R 21"x15"
• E	DETOUR WEST 136	M4-8 24"x12" M3-4 24"x12" M1-5 30"x24" M5-1R 21"x15"
• F	DETOUR WEST 136	M4-8 24"x12" M3-4 24"x12" M1-5 30"x24" M6-3 21"x15"
• G	END DETOUR WEST 136	M4-8A 24"x18" M3-4 24"x12" M1-5 30"x24"
• H	ROAD CLOSED 1/2 MILE	W20-3 36"x36" W30-1-4 20"x6"
• I	ROAD CLOSED 500 FT	W20-3 36"x36" W30-1-1 20"x6"
• J	ROAD CLOSED 1000 FT	W20-3 36"x36" W30-1-2 20"x6"
• L	ROAD CLOSED	R11-2 48"x30"
• M	ROAD CLOSED	R11-2 48"x30"
• N	THIS BRIDGE TO BE CLOSED FOR CONSTRUCTION MM/DD/YYYY	W23-101 96"x48"
• R	DETOUR 1500 FT	W20-2 36"x36" W30-1-3 20"x6"
• S	DETOUR 1/2 MILE	W20-2 36"x36" W30-1-4 20"x6"
• T	DETOUR EAST 136	M4-8 24"x12" M3-2 24"x12" M1-5 30"x24" M6-3 21"x15"
• U	DETOUR WEST 136	M4-8 24"x12" M3-4 24"x12" M1-5 30"x24" M5-1L 21"x15"
• V	DETOUR WEST 136	M4-8 24"x12" M3-4 24"x12" M1-5 30"x24" M6-1 21"x15"
• X	DETOUR EAST 136	M4-8 24"x12" M3-2 24"x12" M1-5 30"x24" M6-1 21"x15"
• Y	DETOUR EAST 136	M4-8 24"x12" M3-2 24"x12" M1-5 30"x24" M5-1L 21"x15"
• Z	ROAD CLOSED 2 MILES AHEAD LOCAL TRAFFIC ONLY	R11-3A 60"x30"

- LEGEND**
- XXXXX AREA OF CLOSURE
 - DETOUR ROUTE
 - TRAFFIC FLOW
 - TT TEMPORARY SIGN
 - II TYPE III BARRICADE
 - (A) SIGN LETTER

DETOUR LENGTH = 10.85 MILES
MAP NOT TO SCALE

* - TYPE III BARRICADE OR POST MOUNTED TYPE B SIGNS

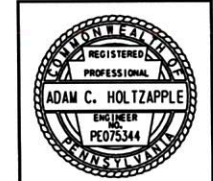

DETOUR PLAN
SR 136 CLOSED
TRAFFIC CONTROL PLAN

USER: WPROVENZ
 PLOT DATE: 03-02-2016 9:11:46 AM
 PATH: D:\00001\COM0094634\00000000245912\6_0_CAD_BITMAP_2_Rev_K_In_Progress.dwg
 FILE: RBRP-JV543-TC-DETOUR.dgn